



**Upton Beginners Regatta  
10<sup>th</sup> September 2017**

# **Safety Plan**

## Emergency Phone Numbers

Regatta Chairman ( <i>Maurice Stanley</i> )	07587 178254
Race Chairman ( <i>Ron Paterson</i> )	07815 533356
URC Captain ( <i>Maurice Stanley</i> )	07587 178254
Safety Advisor ( <i>Peter Barker</i> )	07974 158838
Club Welfare Officer ( <i>Trish Scorer</i> )	07798 876014
Regatta Welfare Officer ( <i>Jo Hammett</i> )	07740 611684
Water Rescue UK ( <i>Richard Bailey</i> )	07836 617158, 07789 380337

## Contents

Emergency Phone Numbers.....	2
<b>1.Introduction .....</b>	<b>4</b>
<b>2.Event Organisation .....</b>	<b>4</b>
Event Committee .....	4
<b>3.Communications .....</b>	<b>4</b>
Prior to the Event .....	4
At the start of the event .....	5
During the event .....	5
Post event.....	5
<b>4.The Course .....</b>	<b>5</b>
Boating & Circulation Pattern.....	5
Start .....	6
Safety Marshals .....	6
<b>5.Regatta Safety: .....</b>	<b>6</b>
‘On water’ and ‘on land’ safety cover: .....	7
<b>6.Accidents and Emergencies: .....</b>	<b>7</b>
Emergency Response Plan .....	8
First Aid Cover .....	8
Emergency Services .....	8
Regatta Incidents:.....	8
<b>7.Measures for Specific Risks – .....</b>	<b>8</b>
Safety briefing.....	8
On Water Safety .....	8
On Land Safety.....	9
Weather and river conditions .....	9
Failure of safety arrangements .....	9
<b>8.Welfare .....</b>	<b>9</b>

# Upton Beginners Regatta 2017 – Safety Plan

## 1 Introduction

This safety plan has been formulated to ensure a safe environment for competitors to take part in racing side by side over a short course at Upton upon Severn. The beginners event was established in 2010 to provide an introductory experience of regatta racing to first and second year rowers. This year the event is open to first year and more experienced rowers. Some of the crews will have limited rowing technique and watermanship so extra care will be needed by all concerned.

The event is hosted by Upton Rowing Club using “committee” recreational boats provided by Upton and Stourport Rowing Clubs. The course will be 500m rowed downstream finishing near the King’s Head Public House in the centre of the town. This safety plan complies with ‘Row Safe: A Guide to Safe Practice in Rowing’. The safety plan explains safety measures that have been introduced as a result of the event risk assessment and specific details linked to BR requirements.

## 2. Event Organisation

### Event Committee

This event is organised by Upton Rowing Club. The Event Committee includes the following personnel:

Regatta Chairman	Maurice Stanley
Race Chairman	Ron Paterson
Captain	Maurice Stanley
Secretary	Peter Barker
RR Vice Captain	Ian Mackie
EWSA	Peter Barker
Welfare officer	Trish Scorer

## 3. Communications

Competitors and organisers will be made aware of the safety arrangements before and during the event in order to help prevent incidents and to enable them to be dealt with efficiently if they do occur. The following actions will be undertaken to ensure effective communication between all parties:

### Prior to the Event

- **Competitors** - All competing clubs, race officials, safety personnel and marshals will receive a copy of this safety plan, the risk assessment and competitors’ instructions. In addition, race officials will receive details of radio protocol and a list of mobile telephone numbers. All these documents are available on the Event Web Page ([www.uptonrc.org/events](http://www.uptonrc.org/events))

# ***Upton Beginners Regatta 2017 – Safety Plan***

---

- ***Other River users*** – the Canal and River Trust, local fishing clubs, trip boats and marina have been informed of the event.

## **At the start of the event**

There will be a safety briefing for all participants and officials by the Event Water Safety Advisor 30 minutes before the first race.

## **During the event**

Communication between the race control, race officials and WRUK will be by radio. A separate radio frequency should be used for an emergency. Race officials will be requested to carry mobile phones with the numbers being held by the Event Chairman so contact can be made easily if other communication methods fail.

## **Post event**

Any feedback or comments on the event safety cover after the event should be sent to the event safety advisor; Peter Barker ([peter@tiltridge.com](mailto:peter@tiltridge.com))

## **4. The Course**

The course is a 500m stretch of river rowed downstream from the Pool House to the finish post near the King's Head Public House.

## **Boating & Circulation Pattern**

Crews will boat and disembark from the landing stage on the south east side of Upton Bridge. Under the control of their race official, they will proceed diagonally across the river and up the north east bank within a buoyed recirculation lane to beyond the start line. They are allowed one practice racing start beyond and moving away from the start line before returning to the start under the control of their race official. The official will start and then follow the race to the finish after which the crews will turn and move back to the landing stage along the south bank. The first half of the race course will be buoyed to keep crews separated and prevent them cutting the corner. There will be a half boat length stagger at the start in favour of the town side crew (ie the crew on the right when facing downstream). This is in addition to any handicap resulting from an imbalance of gender within the competing crews. Having more women than the competing crew will result in a default handicap of 2 seconds for each additional woman in the crew.

# Upton Beginners Regatta 2017 – Safety Plan

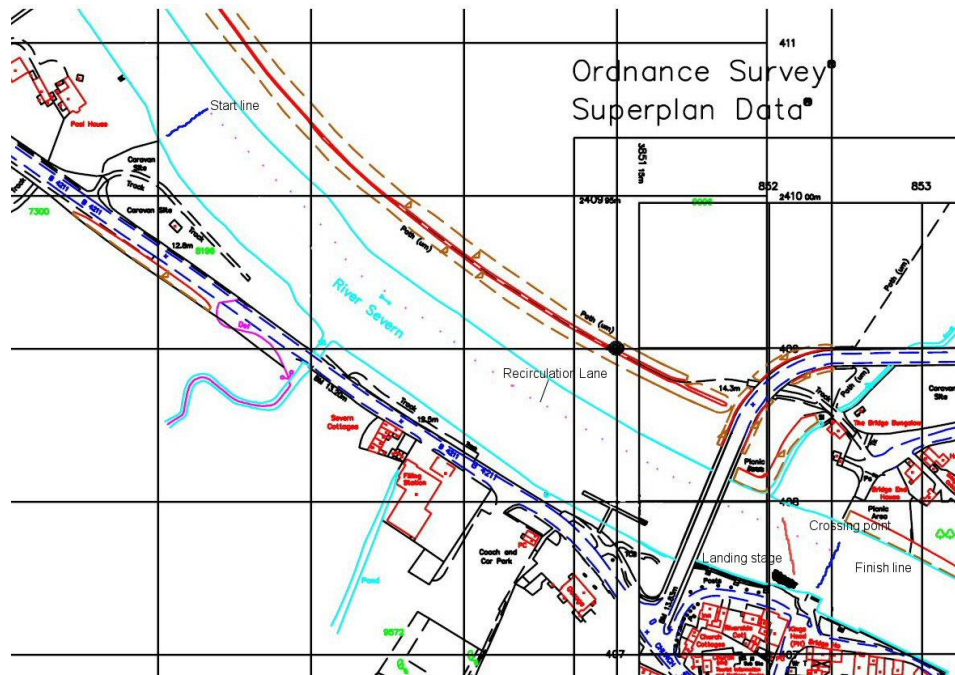

## Start

The races will have a free start directed by the race official in the launch.

## Safety Marshals

The crews are under the control of the race official from the moment they leave the landing stage until after they finish racing. Hence there is no requirement for 'on water' safety marshals. There are officials managing the boating and disembarkation process.

## 5. Regatta Safety:

The regatta will be run according to the latest revision of the British Rowing 'Rules of Racing' and 'Row Safe'. This document and the associated risk assessment will be circulated to British Rowing, Canal and River Trust and Water Rescue UK.

It is compulsory that all crews attending the regatta comply fully with BR Row Safe and the current rules of racing regarding safety (Section 2.2)

The regatta will endeavour to provide a safe environment within the above code.

However, competitors, coxswains & coaches are specifically reminded that persons using the river do so entirely at their own risk & are solely responsible for:-

1. Their own safety, remembering that they have a duty of care to themselves & any third party both on the water & on land.
2. Ensuring that any equipment (e.g. boats, blades, buoyancy aids etc.) are safe & prepared to the standards as required under the 'Rules of Racing' and 'Row Safe'. Any failure in this standard shall result in exclusion from the event.
3. The strict observance of the circulation pattern (see below) and of the provisions of 'Row Safe'.

# **Upton Beginners Regatta 2017 – Safety Plan**

4. Deciding whether or not they are competent to use the river in the prevailing weather conditions and communicating any decision made with the event officials.
5. Ensuring that they can swim in accordance with the provisions of 'Row Safe'

No practising of racing starts is permitted along the length of the course. One only racing start is allowed upstream of the start moving upstream (i.e. away from the start line) but any crews causing delays to the start of their race may be disqualified. 'Committee' stable coxed fours are being used for the racing which will be checked by a race official prior to launching and regularly through the course of the event. However, any defects found during racing should be reported immediately to the marshals upon returning to the landing stage.

## **'On water' and 'on land' safety cover:**

On water safety cover will be provided by Water Rescue UK (WRUK). On land first aid accredited club members will provide First Aid support. On water, there will be a minimum of two boats in attendance at any time, with radio communications. WRUK boats carry a minimum of two crew. Crew members are trained to nationally recognised standards of RYA level 2 Powerboat, RYA Safety boat, RYA VHF communications and First Aid. Boats will be equipped with all equipment required in RowSafe.

The locations of these safety boats will be at areas of most risk of collision, and at positions to maintain the best possible line of site to allow for rapid casualty extraction from the water if required. These points will be above the start and one below the finish. The purpose of these boats is to control safe passage for cruising boats both up and down the river as well as safety cover in the event of an incident. The safety launches will also be responsible for advising regatta officials of other river users approaching the race course so that racing can be suspended if necessary.

## **6. Accidents and Emergencies:**

The Regatta will have a network of radios spread along the course. Any Regatta official observing a safety related incident must report it immediately by the nearest available radio link to the Safety Adviser, failing that to Race Control.

The Safety Adviser or Race Control may assume control of the incident or delegate to the on water safety cover. Radio silence may be called for except from those involved in dealing with the incident to allow summoning of additional help if required. Racing may be suspended if an incident has occurred anywhere on the course.

The Safety Adviser or Race Control will liaise with first aiders and WRUK about making a "999" call should the incident require assistance beyond the scope of that available on the Regatta site. All radio users will be advised when conditions return to normal.

**All coaches and crews should ensure that they are familiar with the Risk Assessments and actions that they may be required to take.**

# ***Upton Beginners Regatta 2017 – Safety Plan***

---

## **Emergency Response Plan**

Anyone witnessing an incident should radio or call the Event Safety Advisor. He/she will then alert the safety boat or onshore first aid team. In most cases the safety boat will see the incident or monitor the first radio communication and the second call will not be necessary but this procedure will cover all eventualities. The Event Safety Advisor will monitor the initial response and call for more support or alert the emergency services if required.

## **First Aid Cover**

On water first aid cover is provided by WRUK. If they attend an incident, boating and racing will be suspended until they are able to resume full on-water cover. They will have a defibrillator. On shore first aid cover is provided by first aid accredited members of Upton RC. They can be contacted via race control.

## **Emergency Services**

The nearest NHS accident and emergency services are at Worcester Royal Hospital (*Charles Hastings Way, Worcester, WR5 1DD 01905 763333*). There is a walk-in minor injuries clinic at Malvern Community Hospital (*185 Worcester Road, Malvern Link, WR14 1EX 01684 612600*). Ambulance response times are expected to be 20 minutes.

## **Regatta Incidents:**

A regatta incident book will be held at Race Control at the finish line. All safety related incidents, including near misses, must be recorded in this book and onto the BR online reporting system.

Any competitor, official, coach or spectator is encouraged to log any incidents on the BR website. It is also the duty of each club involved in any incident or near miss to record the details both through their own club system and on the BR online reporting system.

## **7. Measures for Specific Risks –**

Refer to the Risk Assessment.

### **Safety briefing**

An official will provide a verbal safety briefing to coxes prior to the start of racing, highlighting the control from race officials, the rotation pattern and any hazards on the river.

### **On-Water Safety**

Crews will be under the authority of a race official in a launch whenever on the river. The race official will manage any hazards that arise and will be able to summon assistance if required. Specific hazards e.g. obstacles that form a potential collision or safety risk, will be buoyed and will be brought to the attention of coxes.

### **On-Land Safety**

Competitors and spectators on land will be expected to take the normal safety precautions when visiting Upton town. Anyone on the stairs down to the landing



# **Upton Beginners Regatta 2017 – Safety Plan**

stage and on the landing stage itself will be under the authority of the boating marshals. The landing stage will be kept clear at all times and the marshals are to wear life jackets or PFD's.

## **Weather and river conditions**

There will be some weather and river conditions that may require the event to be changed, suspended or even cancelled to avoid unnecessary risk to competitors and officials, the decision on these actions will be taken as early as possible by the Event Chairman with advice from the Safety Advisor. Although it is not possible to set exact rules for these decisions due to the number of variables that exist, a set of guidelines have been set out below:

**Lightning** - Suspend racing and stop boating until storm blows over.

**Flooding** (fast current and/or debris in water or on bridges) - Cancel event.

**Heavy rain** - Ensure appropriate clothing is worn at boat embarkation.

**Strong wind/ cold conditions** – Cancel event. Ensure appropriate clothing is worn at boat embarkation.

## **Failure of safety arrangements**

In the event of the loss of safety boat cover, medical cover or communications breakdown (radios), racing should be cancelled, unless appropriate cover can be arranged.

## **8. Welfare**

This event does not have any Junior competitors although there may be vulnerable adults.

The Event Committee believes that the welfare of all competitors is paramount. Any suspicions, concerns and allegations of harm will be taken seriously and responded swiftly and in an appropriate manner.

The Event Welfare Officer will act as the point of contact for any concerns or allegations and can be contacted via Race Control located at the finish.